

Replacing Spindle Lock Rings
Long Reach Mower LRM6019
FORM 0384

AMADAS



DANGER

Before performing any type of maintenance on this machine, carefully read Chapter 1, Safety in the LRM6019 User Manual.

April 2014

©2014

*LRM6019 Long Reach Mowers are manufactured
by Amadas Industries:*

You can find us on the Web at:

www.amadas.com

or e-mail us at:

amadas@amadas.com

or call us at:

1-757-539-0231

FORM 0384

Replacing Spindle Lock Rings for Long Reach Mower LRM6019

DANGER

Read all Safety Precautions before performing any maintenance on this machine!!

DANGER

NEVER check or perform maintenance on any part of the mower while the tractor is running. Make sure the tractor is in park and the key removed from the ignition before approaching the mower.

1. Position the mower deck so that the spindle head is in the vertical position as shown in the drawing.

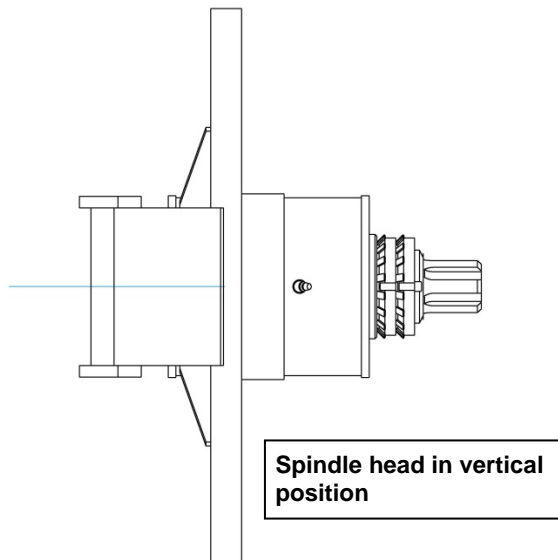

2. Loosen the set screws on the chain coupler sprocket.

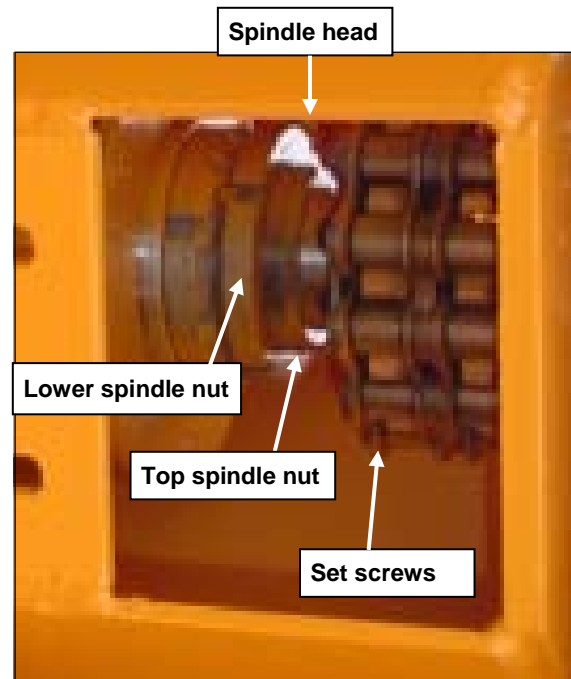

3. Loosen the top spindle nut, moving the nut up as far as possible.
4. Loosen the lower spindle nut.
5. Slide the spindle out of the chain coupler sprocket far enough to remove the spindle nut and lock ring. You may have to loosen the two spindle nuts, first the top and then the bottom, multiple times to get enough clearance to remove the spindle and lock ring.
6. Remove the lower spindle nut.
7. Install the new lower lock ring with the tabs angled up as shown in the drawing on the next page.

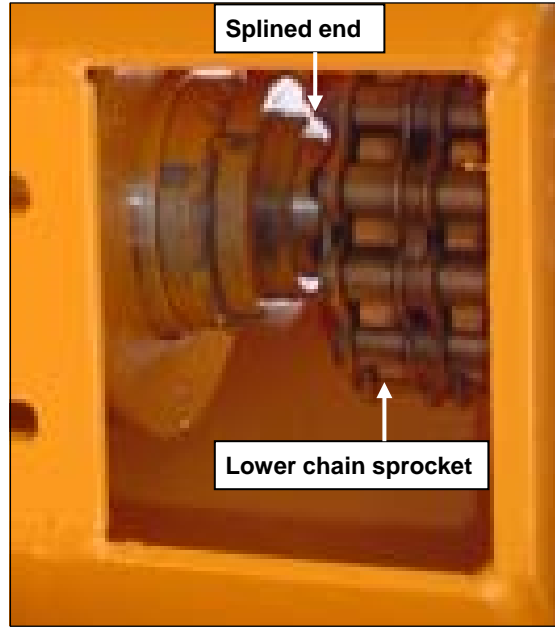
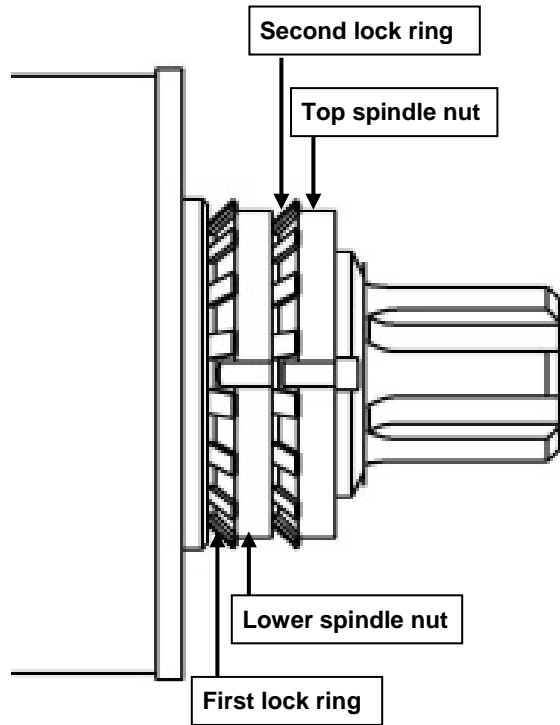

8. Install the lower lock nut and tighten, leaving room for the second lock ring and upper spindle nut.
9. Install the second lock ring and upper spindle nut.
10. Reinsert the splined end of the spindle into the lower chain sprocket.

11. Tighten the spanner nuts as outlined beginning on the next page.

12. Tighten the set screws in the lower chain coupler sprocket.

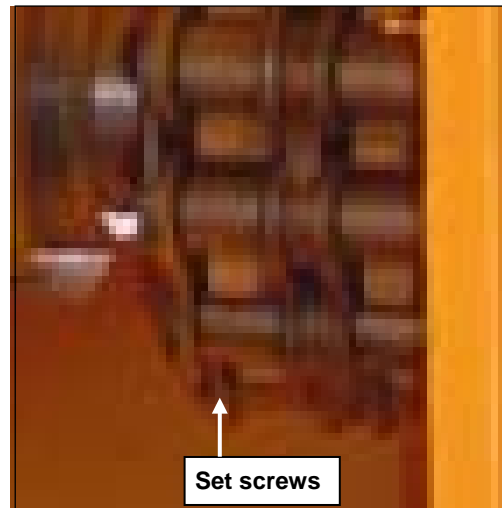

Tighten Spanner Nuts

1. Tighten the spanner nut until a rolling resistance is felt.
2. Roll the spindle housing back and forth to seat cones into cups while continuing to tighten spanner nut.
3. To insure proper bearing shaft seating, the spanner nut must be torqued to create a preload on the bearings. To create the preload:

NOTE! The spanner wrench was not included with mowers with serial numbers PRIOR to 510000. It can be ordered from AMADAS by part number (# 80878).

- a. Temporarily install a $\frac{3}{4}$ " x 3" long bolt into the blade holder bar five inches from the center point as shown in the top drawing on the following page. Tighten to 100 ft lbs.
- b. While holding the spanner nut with the provided wrench, use a torque wrench to tighten the previously installed bolt to 10 ft lbs.
- c. Turn the spindle back and forth to help seat cones. Re-torque and turn the spindle again.

- d. Repeat Step c, re-torquing until the bolt torque stays constant at 10 ft lbs.

4. Adjust the spanner nut to nearest outer tab and using a punch and hammer, bend the tab to lock the spanner nut to spindle.
5. Install second spanner nut washer.
6. Install the second spanner nut as a jam nut and tighten with the provided wrench.
7. Using a punch and hammer, bend the tab up on the washer into the slot to lock second spanner nut.



Bend tab up into slot

8. Remove the $\frac{3}{4}$ " x 3" long bolt installed in Step 3a.

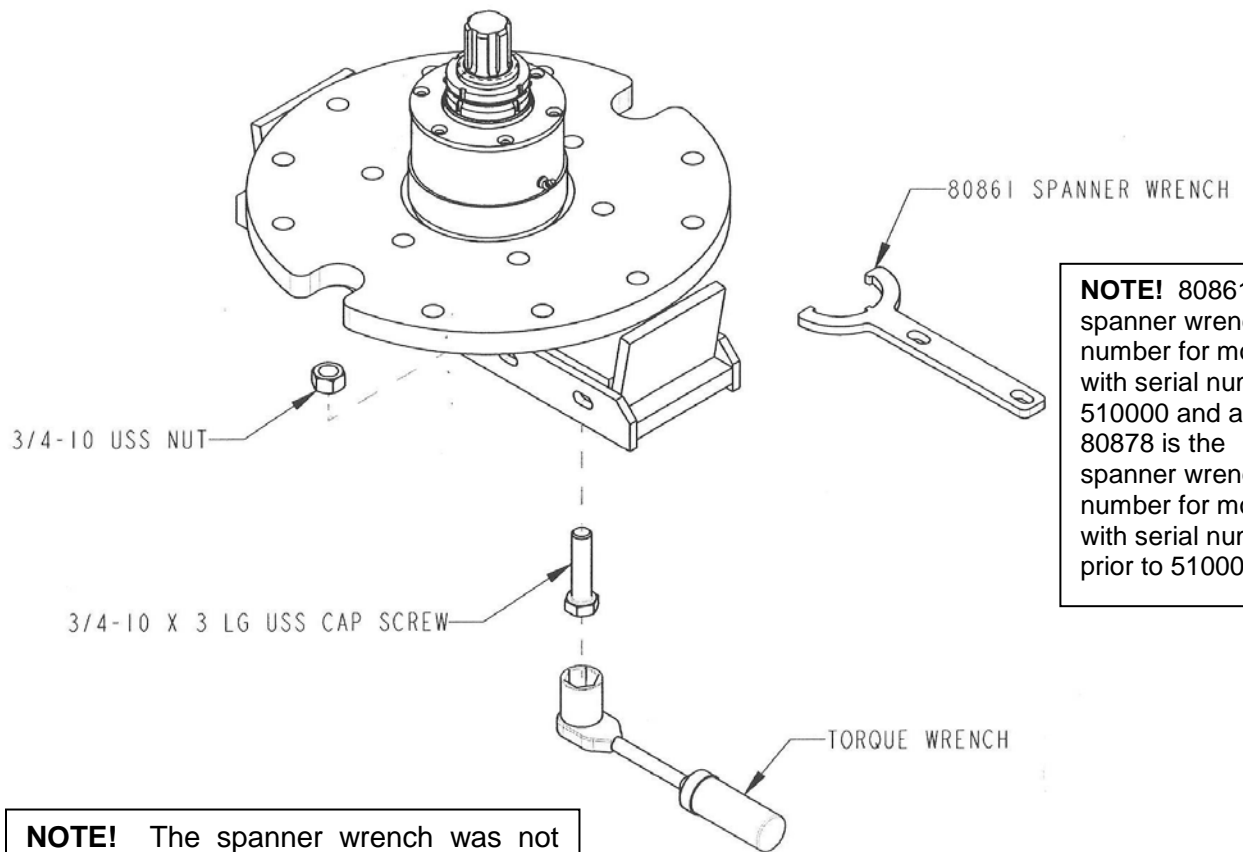
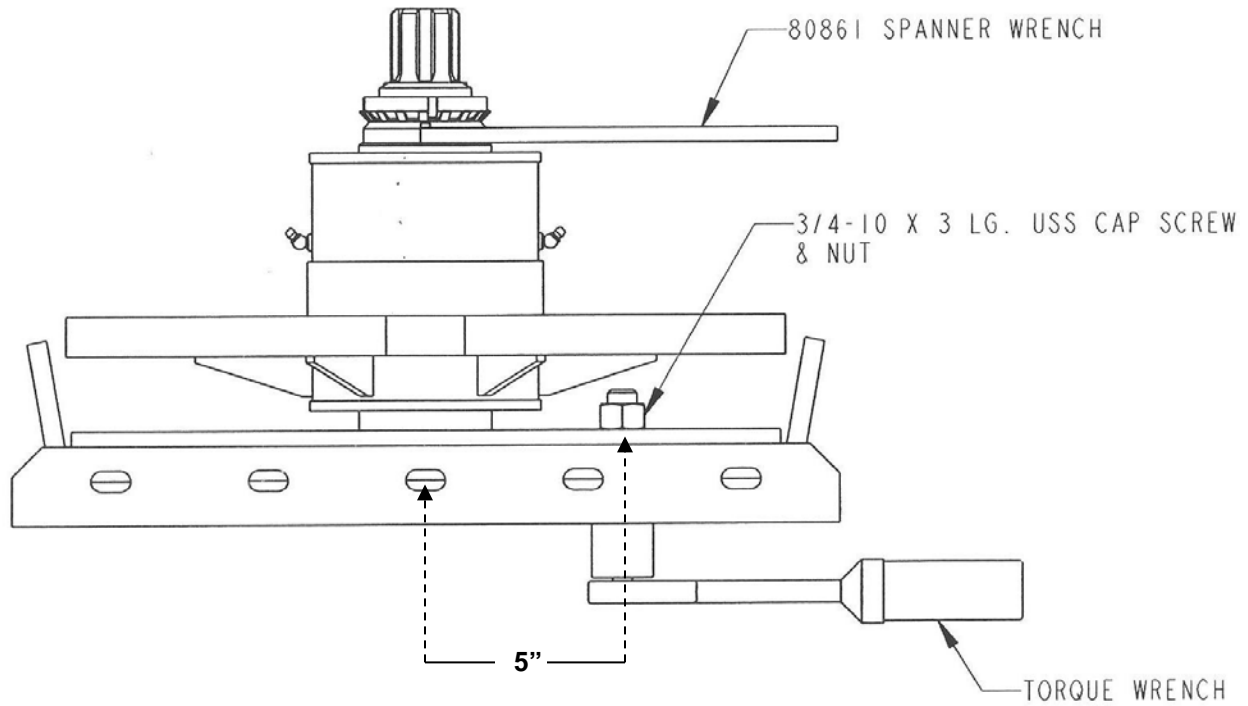

NOTE! 80861 is the spanner wrench part number for mowers with serial numbers 510000 and above. 80878 is the spanner wrench part number for mowers with serial numbers prior to 510000.

NOTE! The spanner wrench was not included with mowers with serial numbers PRIOR to 510000. It can be ordered from AMADAS by part number.

Torque Specifications

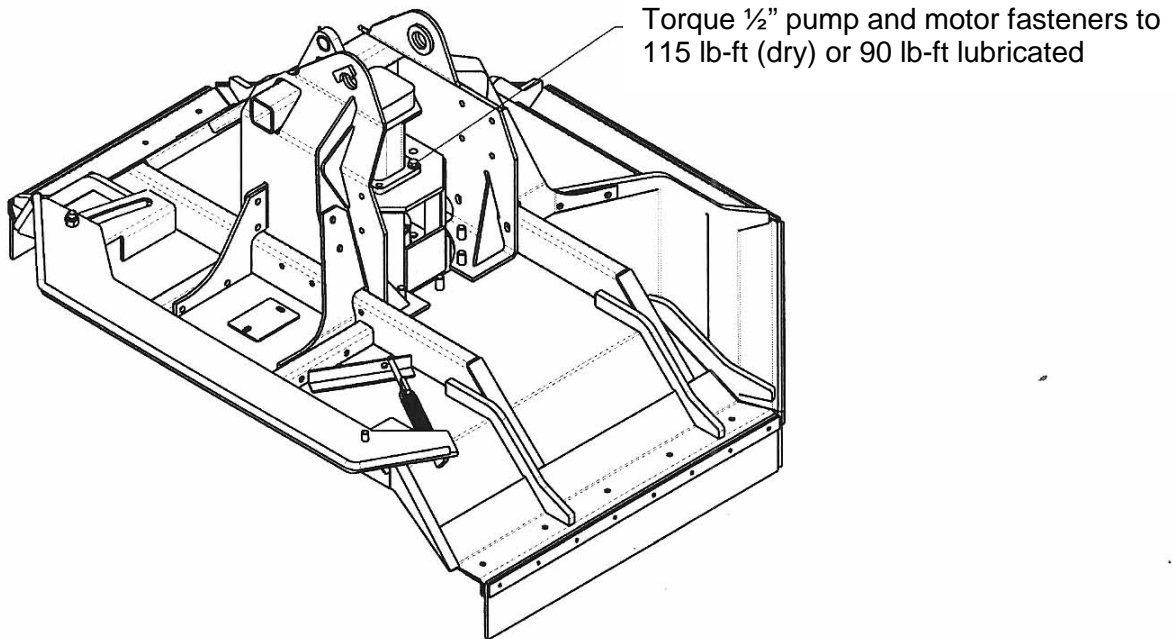

WARNING

To prevent injury or damage to equipment, follow torque specifications.

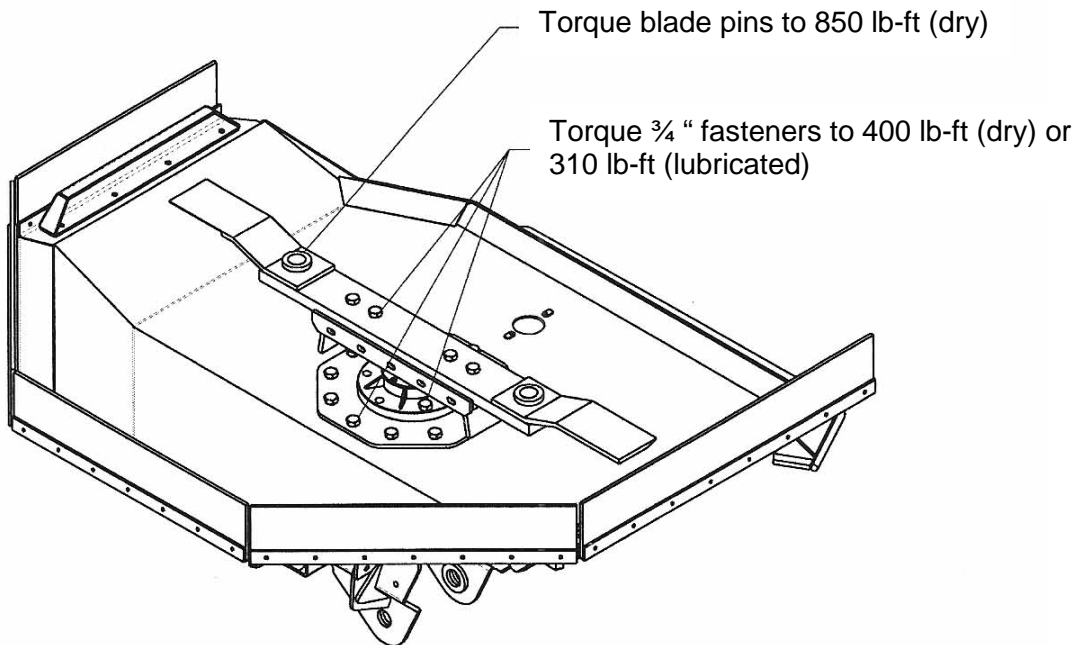

NOTES
